

# ***ALUMINUM 5 ROW x 27'-0" - NATIONAL REP SERIES***

**MODEL**  
***NR-0527AMC***

  
GT GRANDSTANDS™  
A PLAYCORE COMPANY  
2810 Sydney Road  
Plant City, Florida 33566  
Phone: 813-305-1415  
Fax: 813-305-1419  
www.gtgrandstands.com

COVER SHEET  
5 ROW BLEACHER  
8" RISE / 10" SEAT

NR-0527AMC  
OPTIONAL -MS (MUD SILL)  
OPTIONAL -RB (RUBBER BUMPER)

DRAWN BY

MME

CHECKED BY

DATE

08/09/2017

SCALE

JOB NO.

NR-0527AMC

DWG NO.

CS.1

CS.1 - COVER SHEET  
SP.1 - BLEACHER SEATING PLAN  
FB.1 - FRAME AND BRACING  
PP.1 - PLANK PLAN  
BA.1 - BLEACHER ASSEMBLY  
GR.1 - GUARDRAIL ELEVATION  
GR.2 - GUARDRAIL ASSEMBLY  
FP.1 - FOUNDATION PLAN

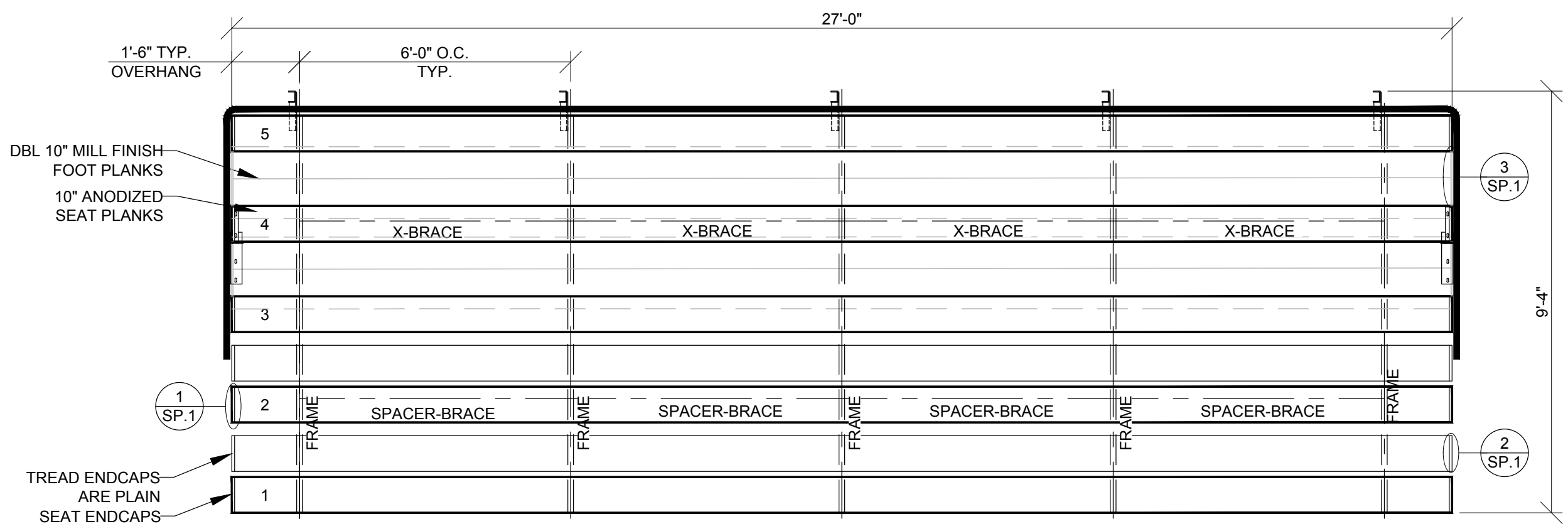
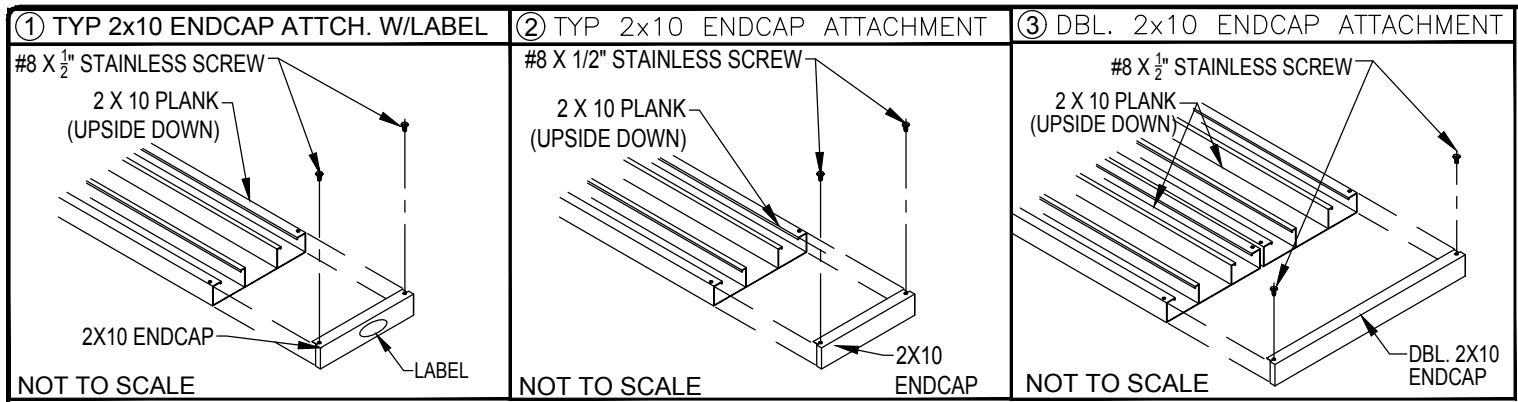

**SEATING PLAN**  
SCALE: 3/8" = 1' - 0"

SECTION LENGTH	GROSS SEATS	ACTUAL SEATS	NO. OF ROWS	NET SEATS
27	18.00	18.00	5	90
			<i>NET SEATS</i>	90
			<i>WHEELCHAIR SPACES</i>	0
			<b>TOTAL NET SEATING CAPACITY</b>	<b>90</b>
			<i>(BASED ON 18" PER SEAT)</i>	

LOCAL CODES AND SPECIFICATIONS WILL VARY FROM REGION TO REGION AND WILL ALSO CHANGE OVER TIME. IT IS THE BUYER'S RESPONSIBILITY TO CHECK LOCAL CODES FOR COMPLIANCE.

2810 Sydney Road  
Plant City, Florida 33566  
Phone: 813-305-1415  
Fax: 813-305-1419  
www.gtgrandstands.com

SEATING PLAN  
5 ROW BLEACHER  
8" RISE / 10" SEAT

NR-0527AMC  
NR SERIES

DRAWN BY  
MME  
CHECKED BY  
DATE  
08/09/2017  
SCALE  
1/2" = 1' - 0"  
JOB NO.  
NR-0527AMC  
DWG NO.  
SP.1

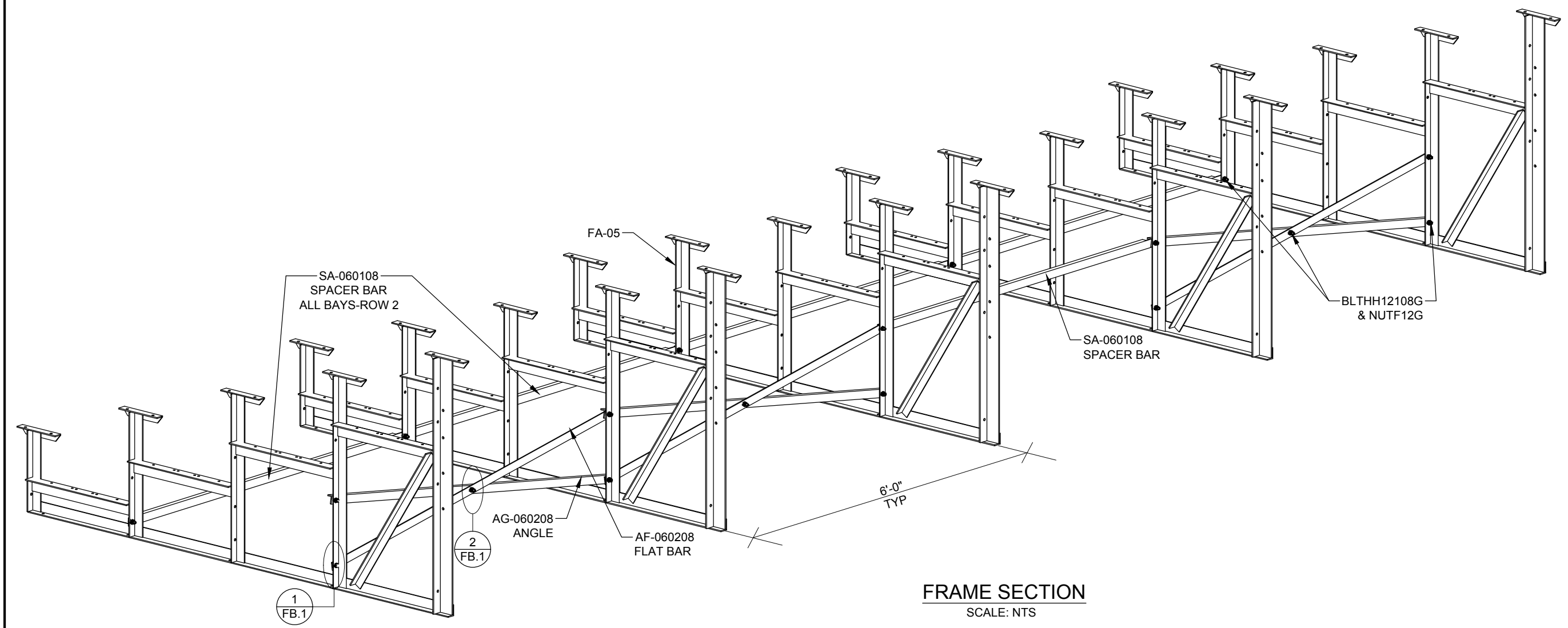
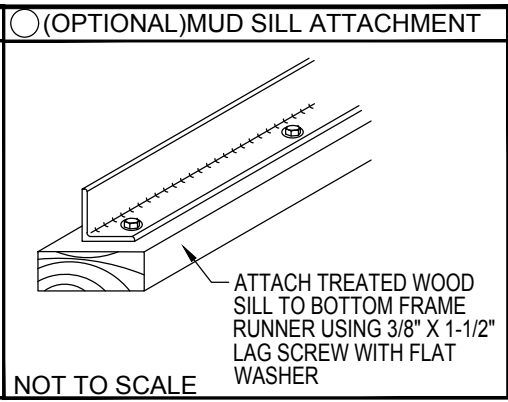
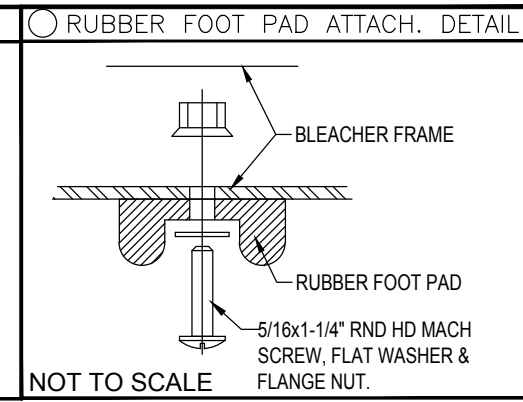
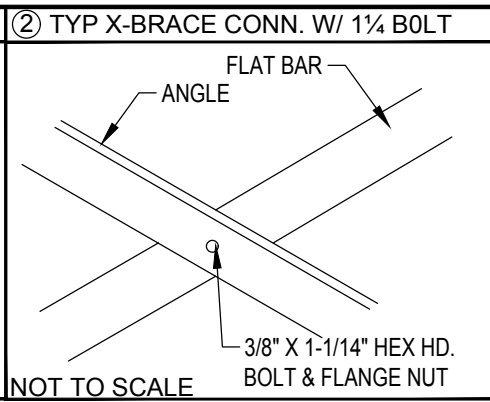
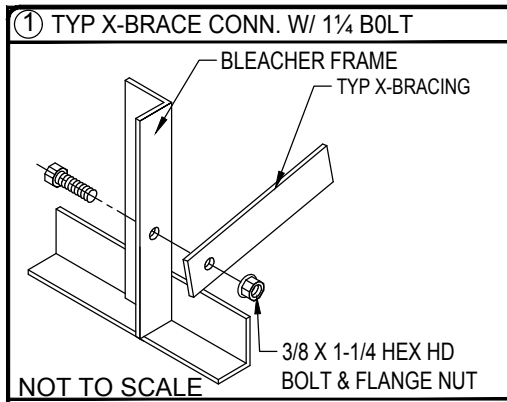

PRE-ASSEMBLE X-BRACE SETS. EACH SET CONSISTS OF A ANGLE AND FLAT BAR. PLACE THE PIECES TOGETHER AT THE FLAT SIDE AND CONNECT USING A 3/8" X 1 1/4 HEX BOLT & FLANGE NUT.

2810 Sydney Road  
Plant City, Florida 33566  
Phone: 813-305-1415  
Fax: 813-305-1419  
www.gtgrandstands.com

A PLAYCORE COMPANY

FRAME AND BRACING  
5 ROW BLEACHER  
8" RISE / 10" SEAT

NR-0527AMC  
OPTIONAL -MS (MUD SILL)  
OPTIONAL -RB (RUBBER BUMPERS)

DRAWN BY  
MME  
CHECKED BY

DATE  
08/09/2017

SCALE  
AS SHOWN

JOB NO.

NR-0527AMC  
DWG NO.

FB.1

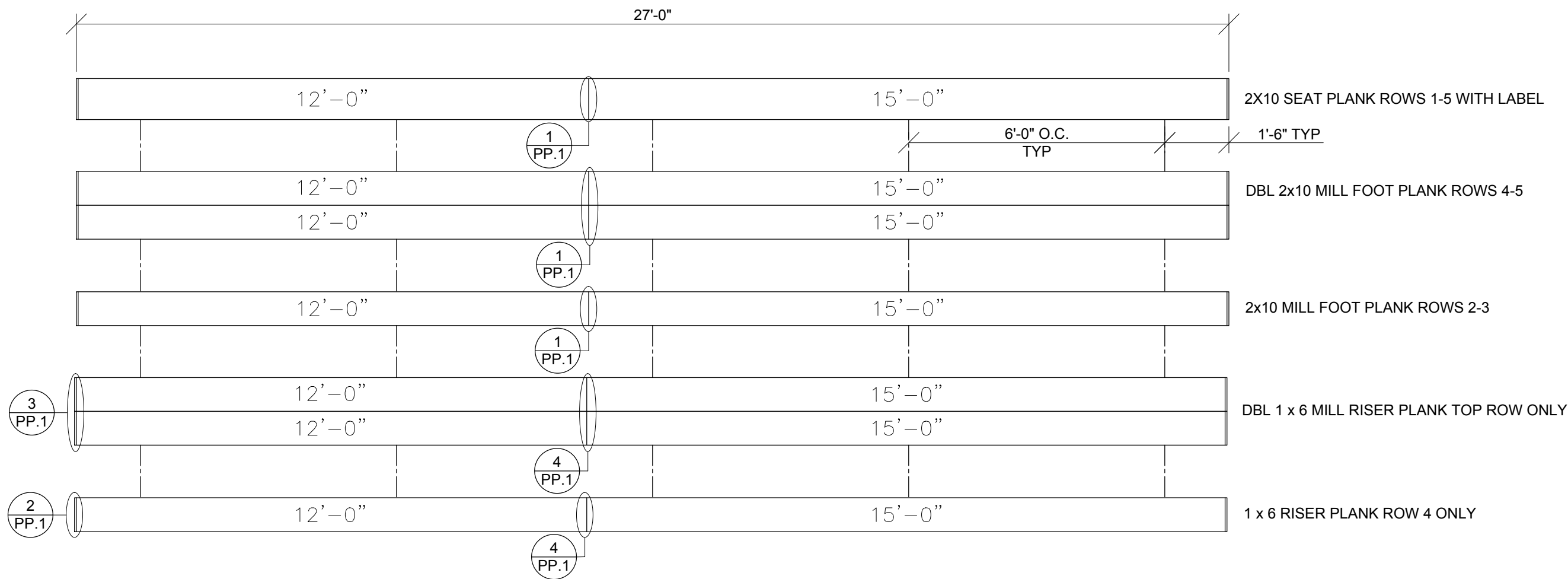
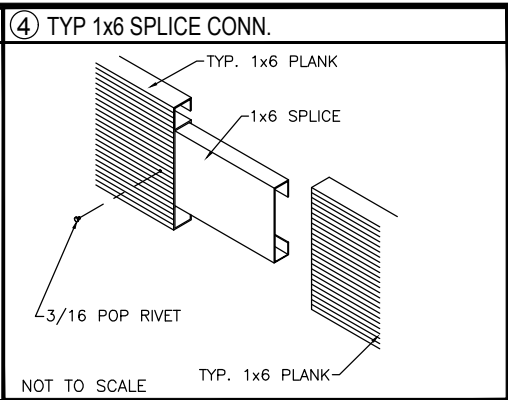
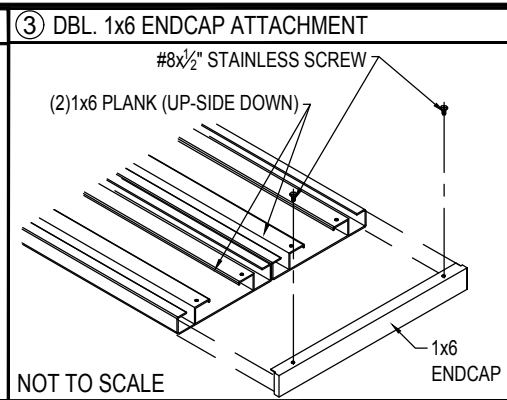
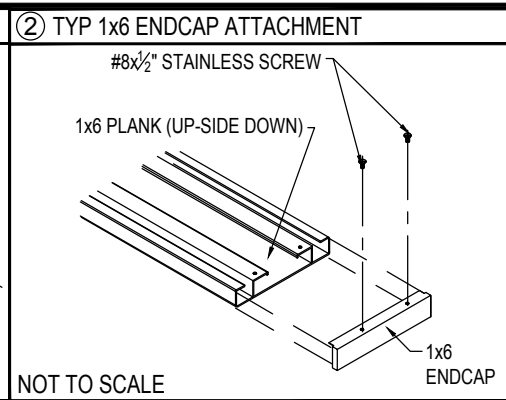
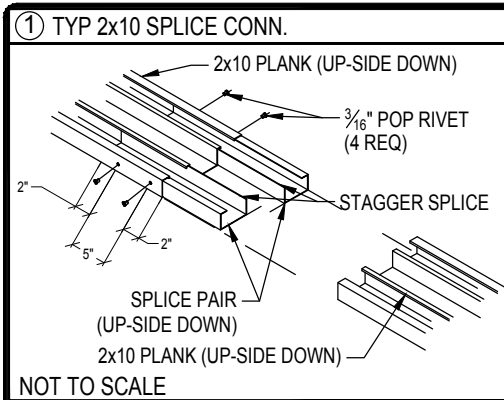

**PLANK PLAN**  
 SCALE: 3/8" = 1' - 0"

2810 Sydney Road  
 Plant City, Florida 33566  
 Phone: 813-305-1415  
 Fax: 813-305-1419  
 www.gtgrandstands.com

PLANK PLAN  
 5 ROW BLEACHER  
 8" RISE / 10" SEAT

NR-0527AMC  
 OPTIONAL -MS (MUD SILL)  
 OPTIONAL -RB (RUBBER BUMPERS)

DRAWN BY MME
CHECKED BY
DATE 08/09/2017
SCALE AS SHOWN
JOB NO.
NR-0527AMC DWG NO.
PP.1

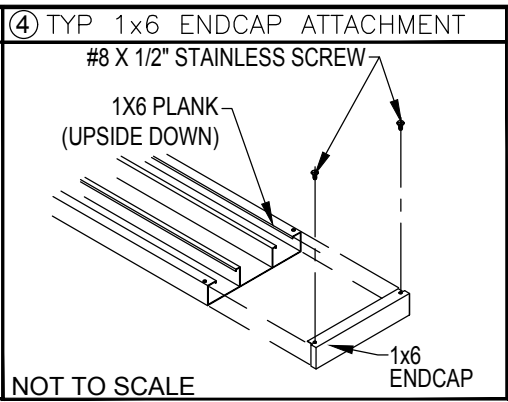
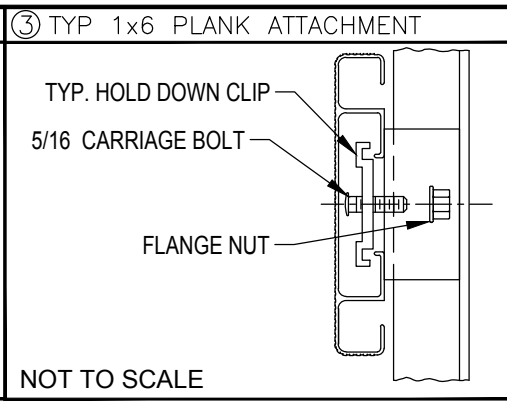
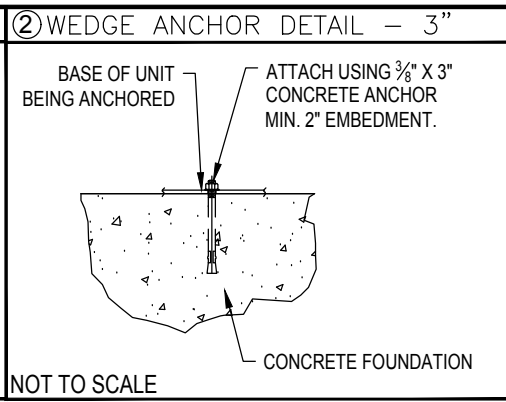
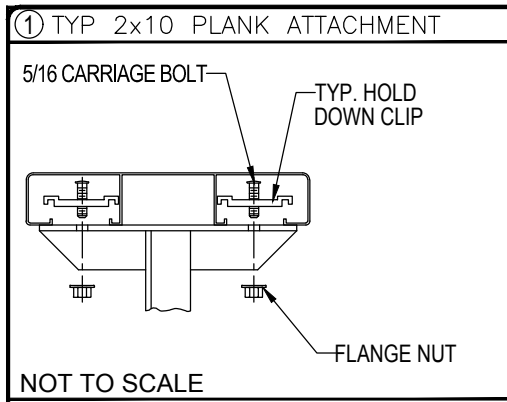

NOTE: LEAVE FLANGE NUT LOOSE UNTIL CLIPS HAVE BEEN SECURED TO PLANKS.

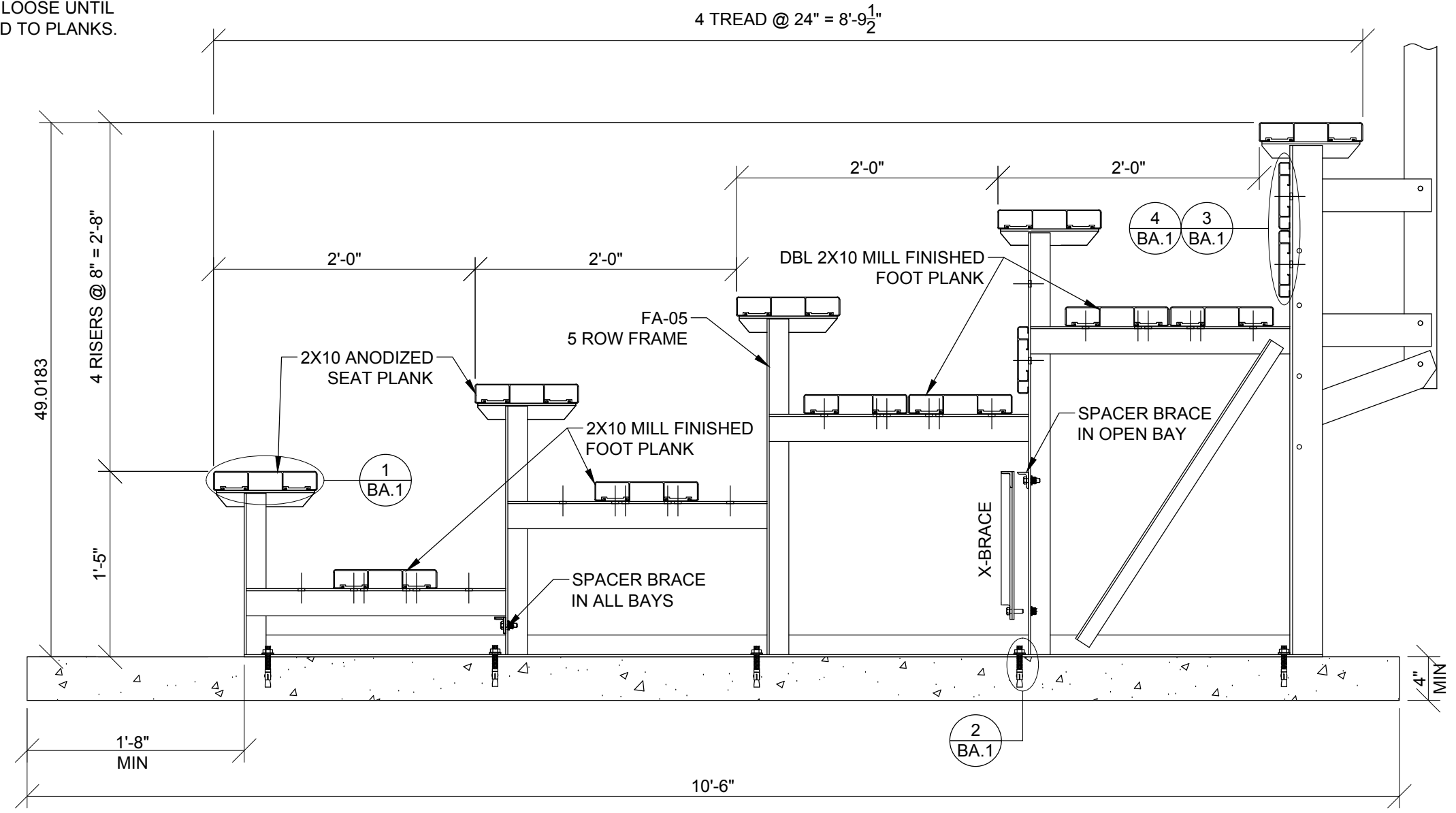

**BLEACHER ASSEMBLY**  
SCALE: 1" = 1' - 0"

\*CONCRETE WEDGE ANCHORS NOT INCLUDED WITH ALL UNITS. IF USING OTHER ANCHORING SYSTEM, SKIP THIS STEP AND REFER TO INSTRUCTIONS SPECIFIC TO THE ANCHORING SYSTEM PURCHASED FOR YOUR UNIT. SEE PRINT FP.1 (INCLUDED IN THIS PACKET) FOR GENERAL CONCRETE FOUNDATION SPECIFICATIONS.

2810 Sydney Road  
Plant City, Florida 33566  
Phone: 813-305-1415  
Fax: 813-305-1419  
www.gtgrandstands.com

**GT**  
GT GRANDSTANDS™  
A PLAYCORE COMPANY

BLEACHER ASSEMBLY  
5 ROW BLEACHER  
8" RISE / 10" SEAT

NR-0527AMC  
(OPTIONAL CONCRETE FOUNDATION)  
NR SERIES

DRAWN BY  
MME  
CHECKED BY  
DATE  
08/09/2017  
SCALE  
AS SHOWN  
JOB NO.  
NR-0527AMC  
DWG NO.  
**BA.1**

**DETAIL "A"**

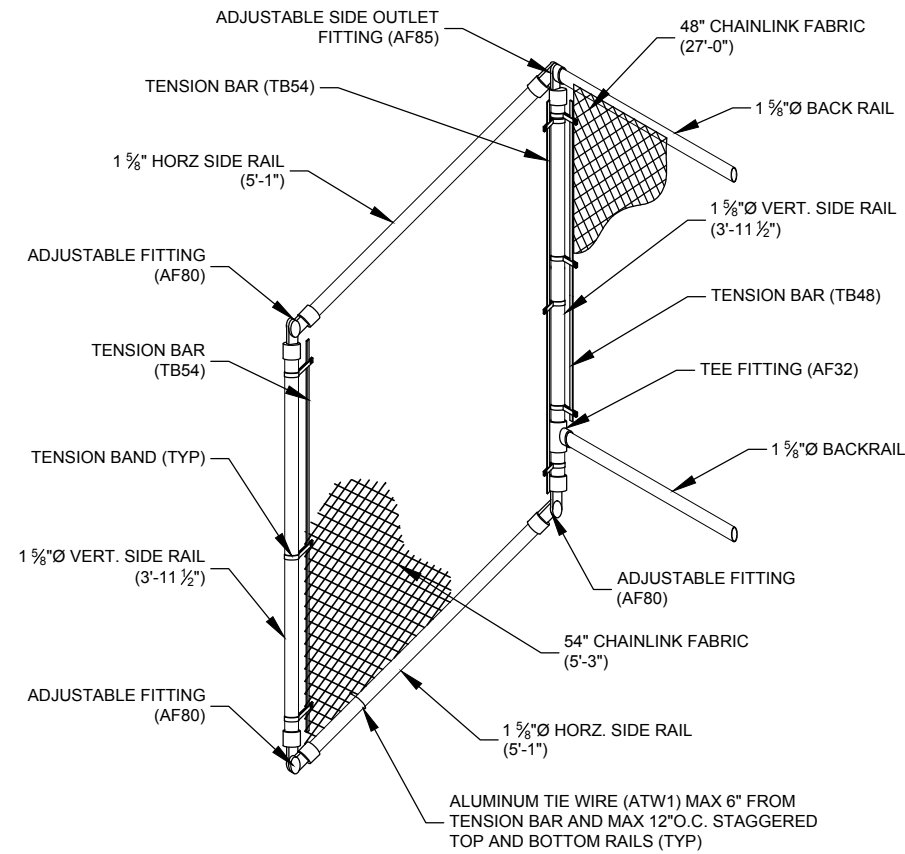

**REAR GUARDRAIL**

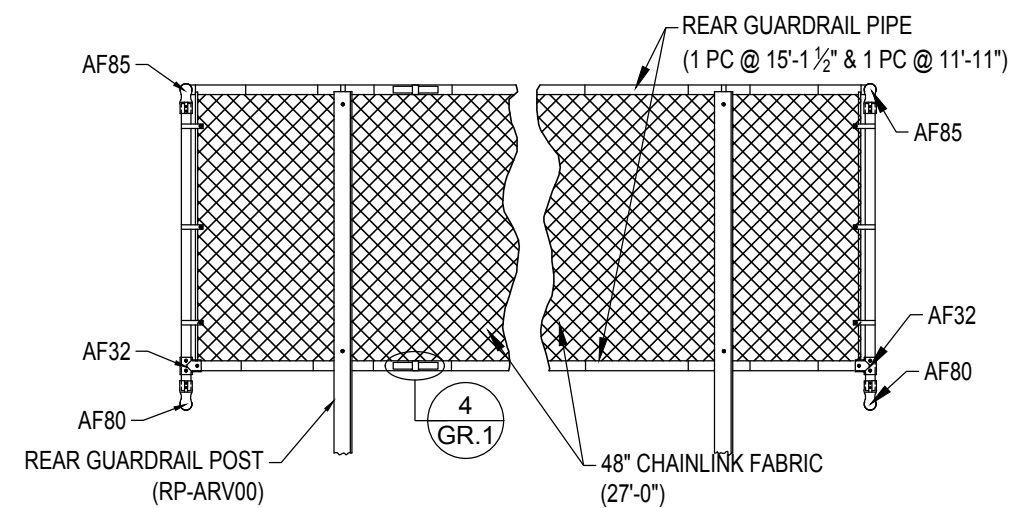

**① REAR GUARDRAIL POST ATTACH.**

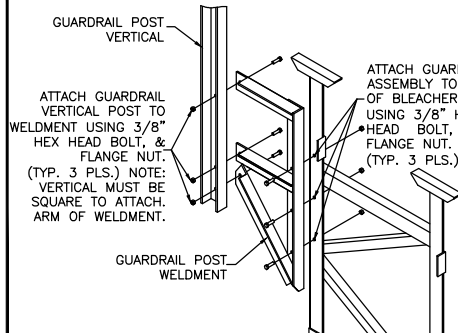

**② SIDE GD. RAIL POST INSTALLATION**

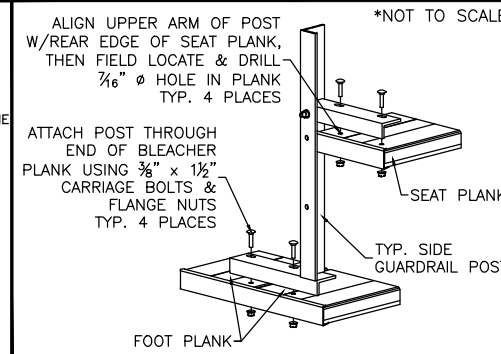

**③ TENSION BAND ATTACHMENT**

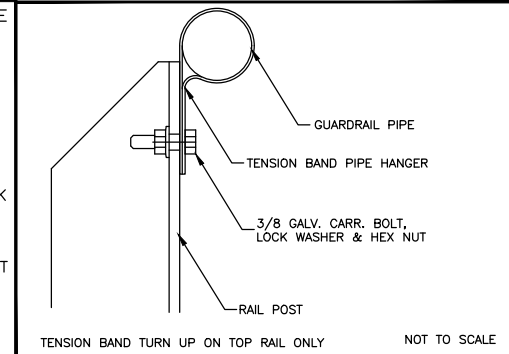

**④ PIPE COUPLER INSTALLATION**

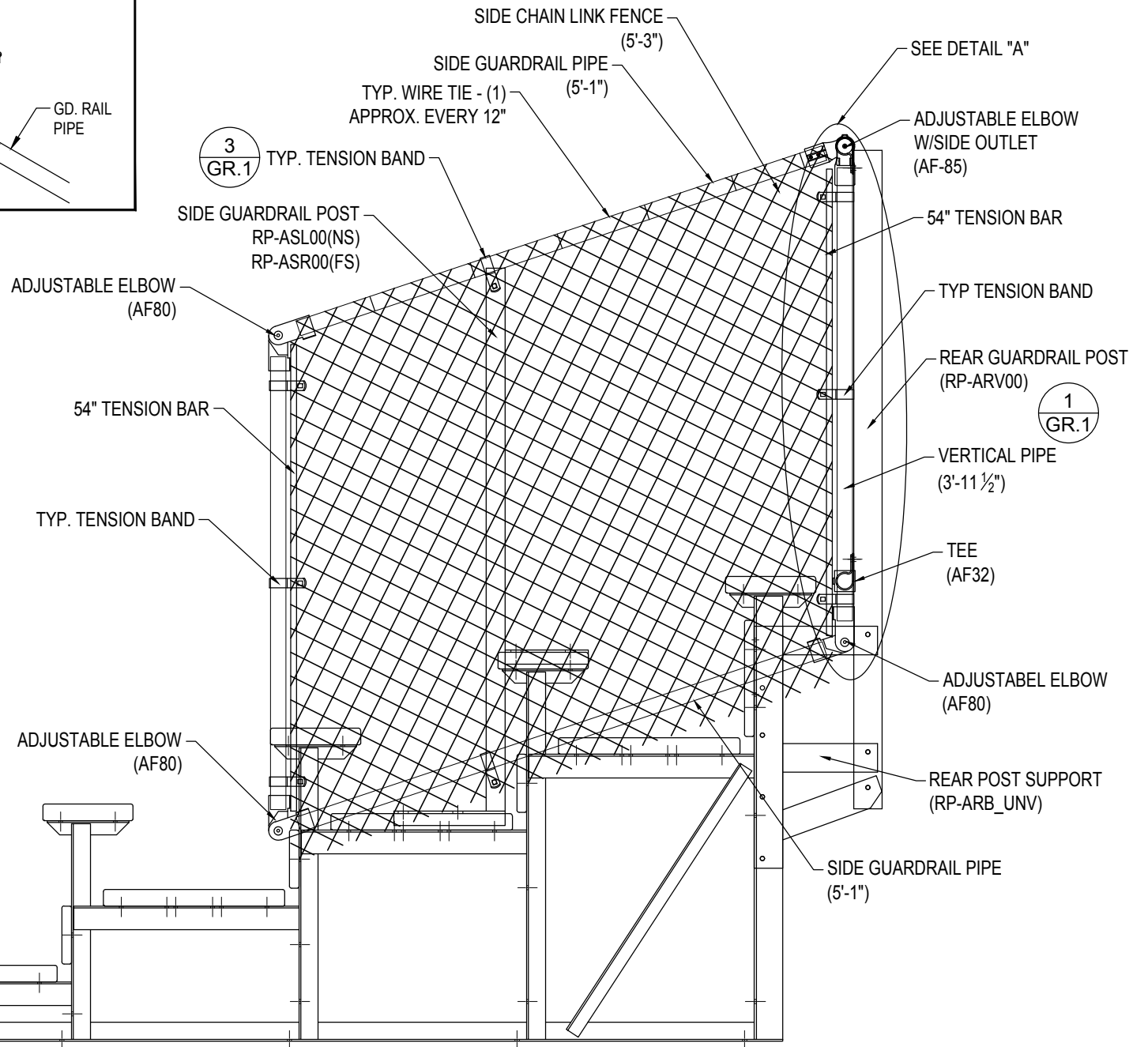
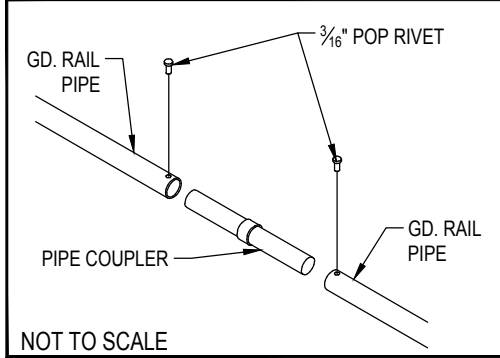

**GUARDRAIL ELEVATION**

SCALE: 3/4" = 1' - 0"

2810 Sydney Road  
Plant City, Florida 33566  
Phone: 813-305-1415  
Fax: 813-305-1419  
www.gtgrandstands.com

FRAME AND BRACING  
5 ROW BLEACHER  
8" RISE / 10" SEAT

NR-0527AMC  
GUARDRAIL ELEVATION

DRAWN BY  
MME  
CHECKED BY  
DATE  
08/09/2017  
SCALE  
AS SHOWN  
JOB NO.

NR-0527AMC  
DWG NO.

GR.1

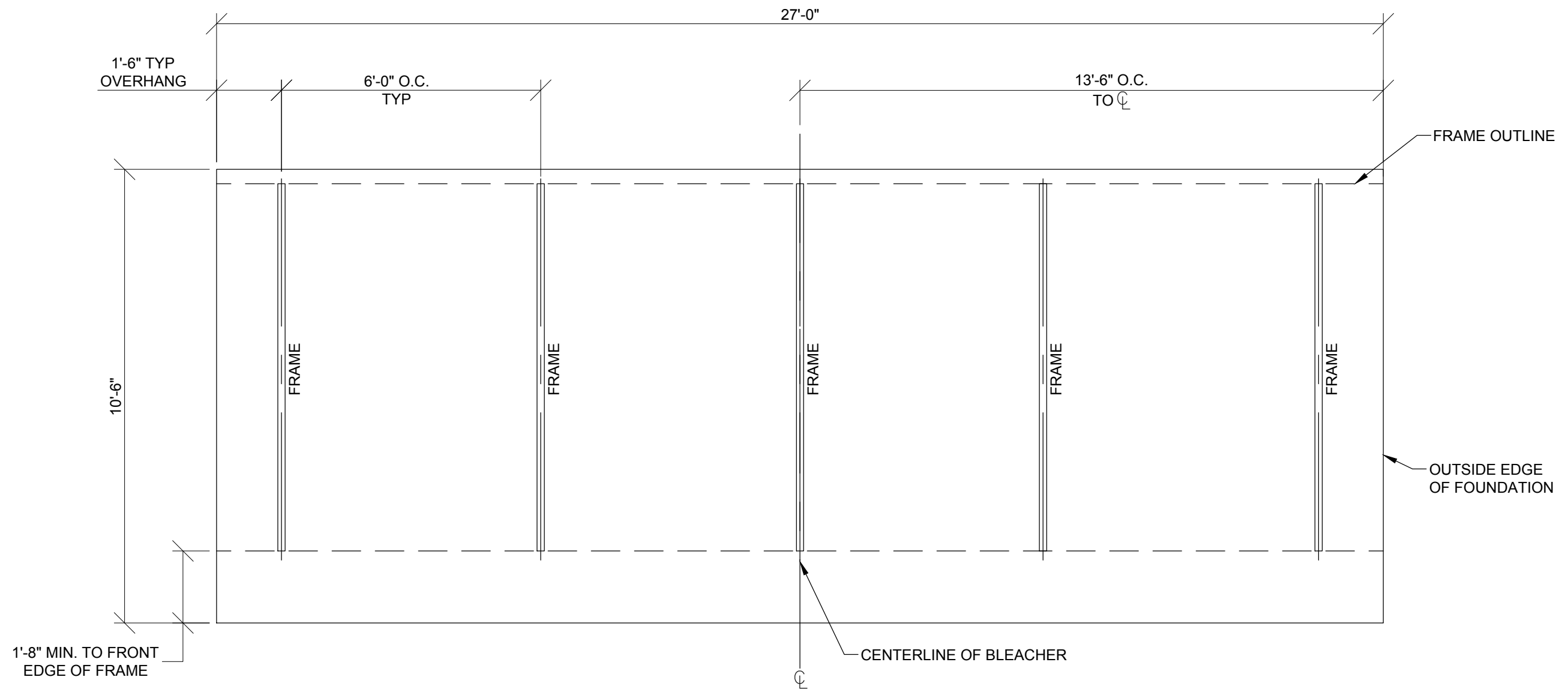

**OPTIONAL FOUNDATION PLAN\***

SCALE: 3/8" = 1' - 0"

\* MINIMUM FOUNDATION AREA SHOWN. DEPENDING ON LOCAL SOIL CONDITIONS, BLEACHER CAN BE INSTALLED ON A CONCRETE PAD OR FOOTERS, OR ATTACHED TO 2x6 TREATED LUMBER GROUND SILLS AND PLACED ON COMPACTED STONE, ASPHALT, OR ANY OTHER SMOOTH, SOLID, LEVEL SURFACE. CONSULT YOUR LOCAL CONCRETE CONTRACTOR TO DETERMINE PROPER CONCRETE SPECIFICATIONS FOR YOUR LOCAL SOIL AND WEATHER-RELATED CONDITIONS. THE BEARING SURFACE MUST BE CAPABLE OF SUPPORTING A MINIMUM OF 660 POUNDS PER LINEAR FOOT. TO MEET LOCAL CODES, BLEACHERS WILL NEED TO BE ANCHORED. ANCHORING SYSTEMS FOR ALL SURFACE TYPES ARE AVAILABLE - CONTACT YOUR BLEACHER SALES REPRESENTATIVE FOR MORE INFORMATION.

2810 Sydney Road  
Plant City, Florida 33566  
Phone: 813-305-1415  
Fax: 813-305-1419  
www.gtgrandstands.com

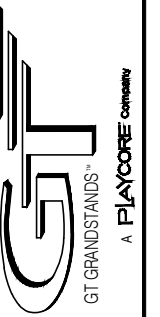

FOUNDATION PLAN  
5 ROW BLEACHER  
8" RISE / 10" SEAT

NR-0527AMC  
NR SERIES

DRAWN BY  
MME

CHECKED BY

DATE  
08/09/2017

SCALE  
3/8" = 1' - 0"

JOB NO.

NR-0527AMC  
DWG NO.

FP.1